



# "Gulf Armor" WOOD GLAZED OR OPAQUE DOUBLE DOOR w/ TRANSOM INSWING/OUTSWING "IMPACT"

**GENERAL NOTES:**

1. This product has been evaluated and is in compliance with the 6th Edition (2017) Florida Building Code (FBC) structural requirements including the "High Velocity Hurricane Zone" (HVHZ).
2. Product anchors shall be as listed and spaced as shown on details. Anchor embedment to base material shall be beyond wall dressing or stucco.
3. When used in the "HVHZ", this product complies with Section 1626 of the Florida Building Code and does not require an impact resistant covering.
4. For 2x stud framing construction, anchoring of these units shall be the same as that shown for 2x buck masonry construction.
5. Site conditions that deviate from the details of this drawing require further engineering analysis by a licensed engineer or registered architect.
6. Outswing configurations meet water infiltration requirements for "HVHZ".
7. Inswing configurations do not meet the water infiltration requirements for the "HVHZ" and shall be installed only in non-habitable areas or at habitable locations protected by an overhang or canopy such that the angle between the edge of canopy or overhang to sill is less than 45 degrees.

TABLE OF CONTENTS	
SHEET #	DESCRIPTION
1	Typical Elevations, Design Pressures & General Notes
2	Door Panel Details
3	Transom Panel Details
4	Elevations
5	Glazing & Panel Infil Details
6	Horizontal & Vertical Cross Sections (2X Buck)
7	Horizontal & Vertical Cross Sections (1X Buck)
8	Vertical Cross Sections (Thresholds)
9	Buck Anchoring
10	Frame Anchoring
11	Hardware Details
12	Bill of Materials & Components

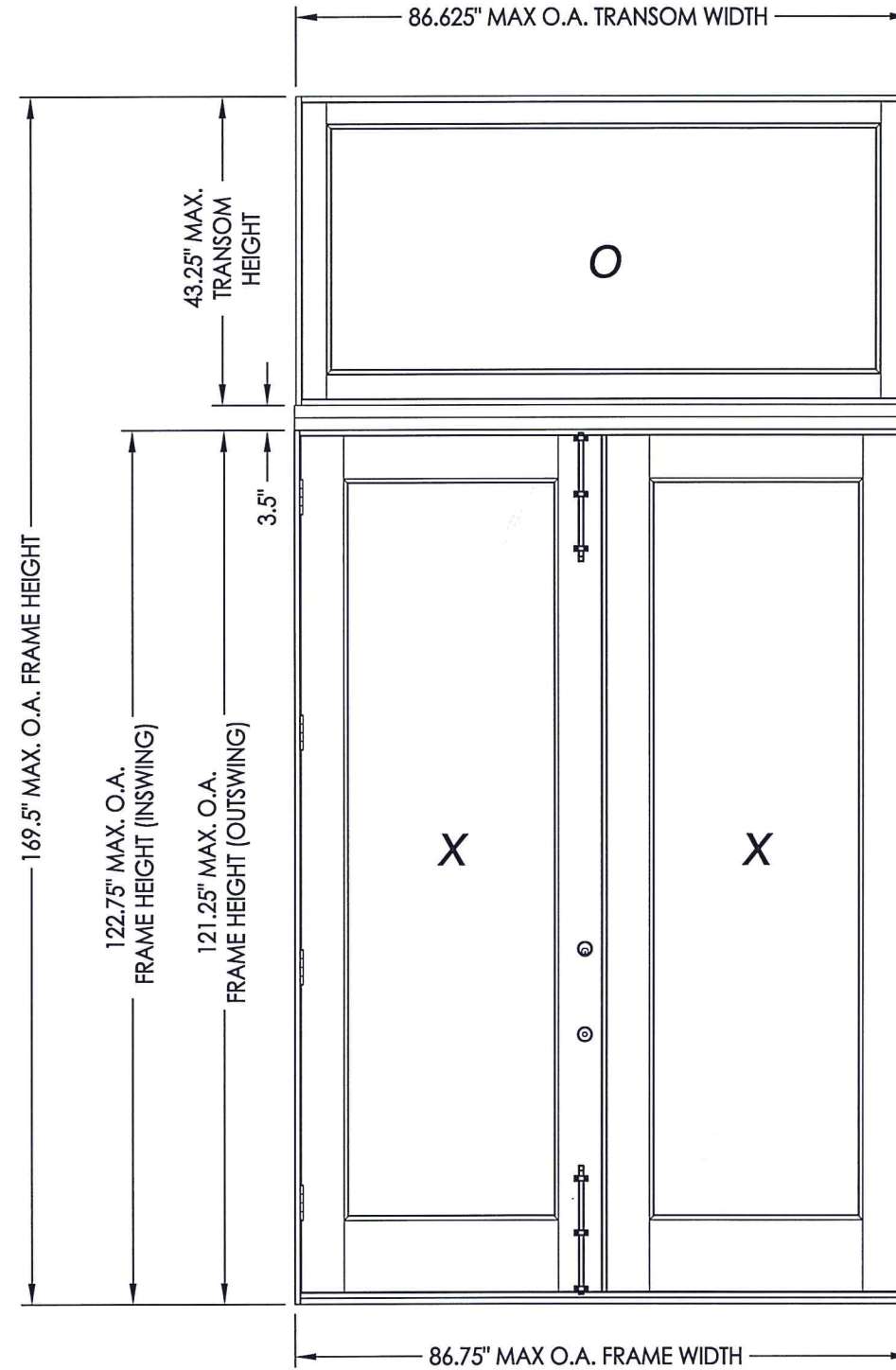

CONFIGURATION	DESIGN PRESSURE (PSF) INSWING		DESIGN PRESSURE (PSF) OUTSWING	
	POSITIVE	NEGATIVE	POSITIVE	NEGATIVE
O XX	+60.0	-70.0	+60.0	-60.0

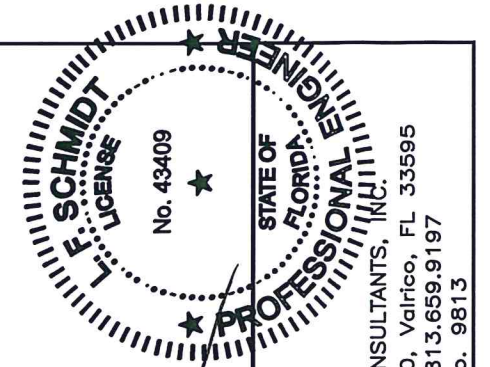

October 12, 2017  
 Documents Prepared By:  
 Lyndon F. Schmidt  
 P.E. No. 43409  
 R.W. BUILDING CONSULTANTS, INC.  
 P.O. Box 230, Valrico, FL 33595  
 Phone No.: 813.659.9197  
 FBPE C.A. No. 9813

PRODUCT:  
 SOUTHEASTERN SASH & DOOR  
 WOOD DOOR  
 PART OR ASSEMBLY:  
 TYPICAL ELEVATION, DESIGN  
 PRESSURES & GENERAL NOTES

NO.	DATE	BY	REVISIONS
1	10/12/17	LFS	UPDATE TO 6TH ED. (2017) FBC

DATE: 5/10/17  
 SCALE: N.T.S.  
 DWG. BY: JK  
 CHK. BY: LFS  
 DRAWING NO.:  
 FL-22347.11  
 SHEET 1 OF 12

R:\Clients\Southeastern Sash & Door\A - Florida Product Approvals\FL-22347C - Drawings\FL-22347 9-11.dwg, 11.2

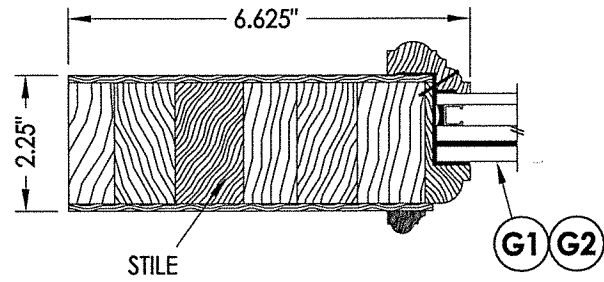

**1**  
**2** HORIZONTAL CROSS SECTION

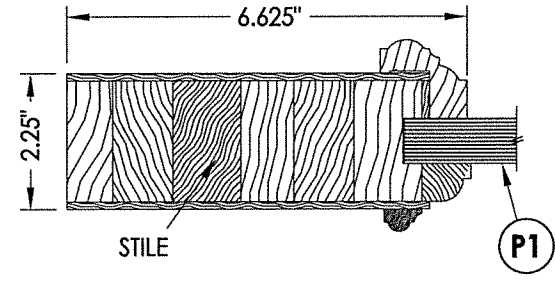

**2**  
**2** HORIZONTAL CROSS SECTION

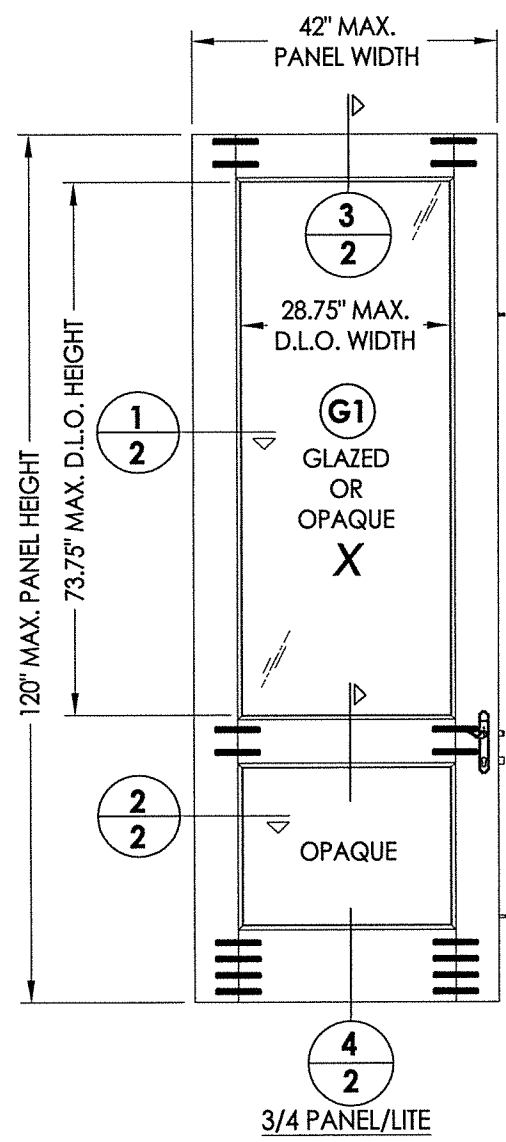

**4**  
**2** 3/4 PANEL/LITE

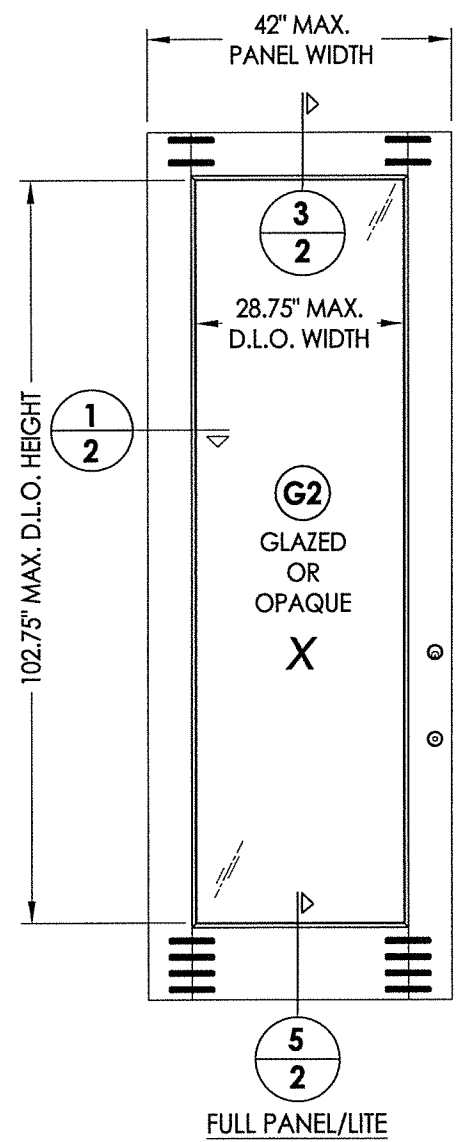

**5**  
**2** FULL PANEL/LITE

**40** WOOD DOOR PANEL (3'-6")  
Glazed or Opaque

WOOD DOOR COMPONENTS:  
ENGINEERED STAVE CORE: SIPO (UTILE) (G = 0.53)  
VENEER/EDGES: CYPRESS (G = 0.42)  
NOTE: VENEER/EDGE MAY INCLUDE OAK, CHERRY, WALNUT OR OTHER OPTIONAL HARDWOOD SPECIES w/ G >= 0.42.

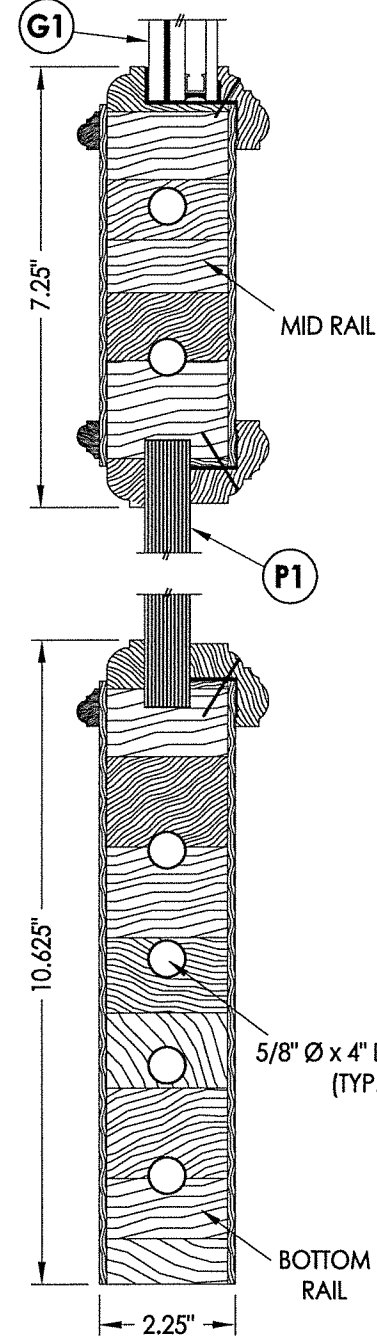

**4**  
**2** VERTICAL CROSS SECTION

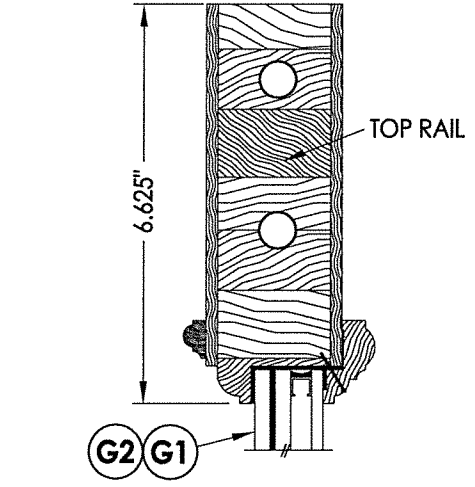

**3**  
**2** VERTICAL CROSS SECTION

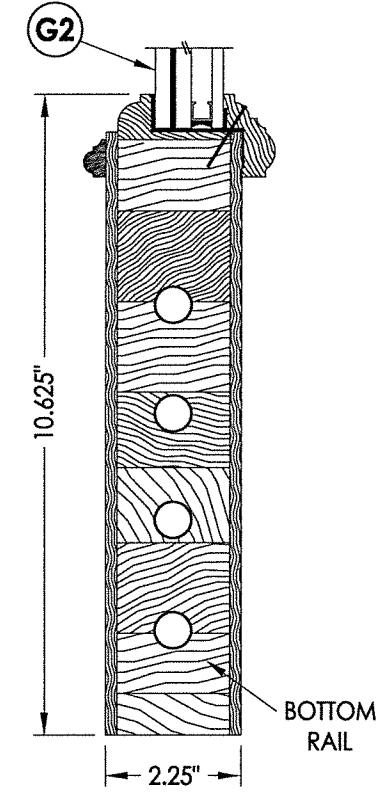

**5**  
**2** VERTICAL CROSS SECTION

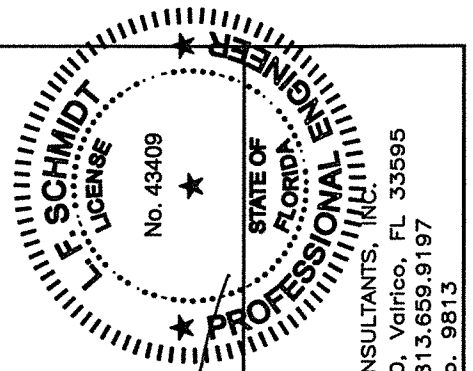

October 12, 2017  
Documents Prepared By:  
Lyndon F. Schmidt  
P.E. No. 43409  
RW BUILDING CONSULTANTS, INC.  
P.O. Box 230, Valrico, FL 33595  
Phone No.: 813.659.9197  
FBPE C.A. No. 9813

PRODUCT:	SOUTHEASTERN SASH & DOOR WOOD DOOR	
PART OR ASSEMBLY:	DOOR PANEL DETAILS	
DATE:	5/10/17	
SCALE:	N.T.S.	
DWG. BY:	JK	
CHK. BY:	LFS	
DRAWING NO.:	FL-22347.11	
SHEET	2 OF 12	
NO.	DATE	REVISIONS
1	10/12/17	UPDATE TO 6TH ED. (2017) FBC
		LFS BY

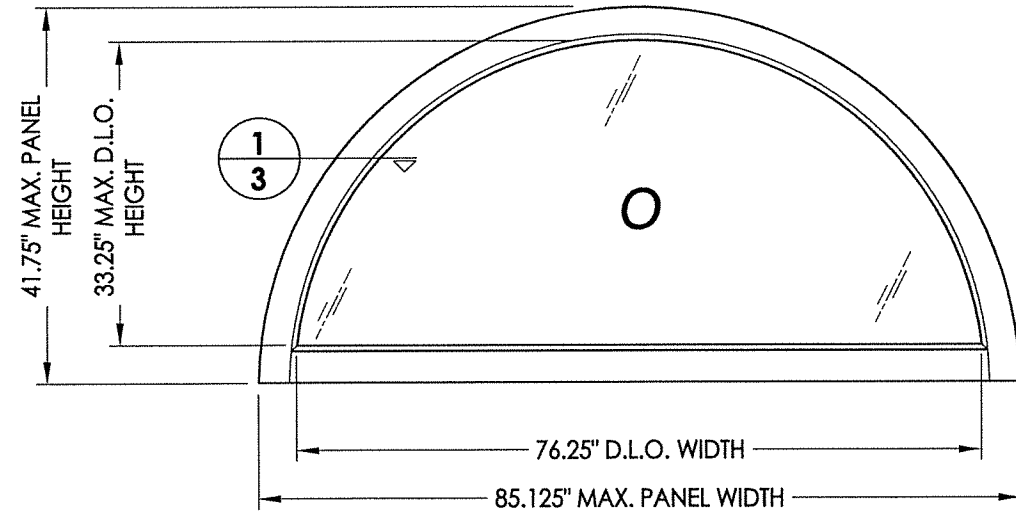

70 WOOD TRANSOM PANEL

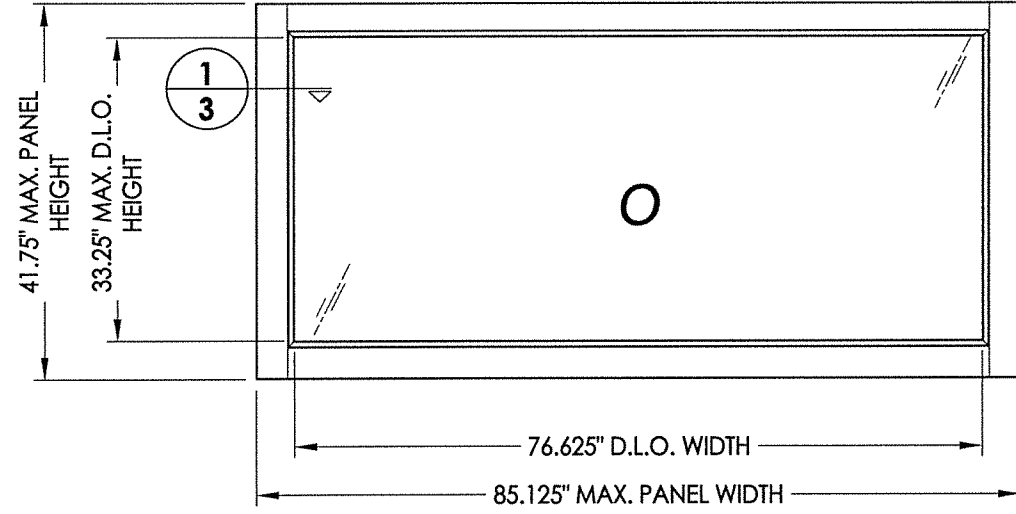

70 WOOD TRANSOM PANEL

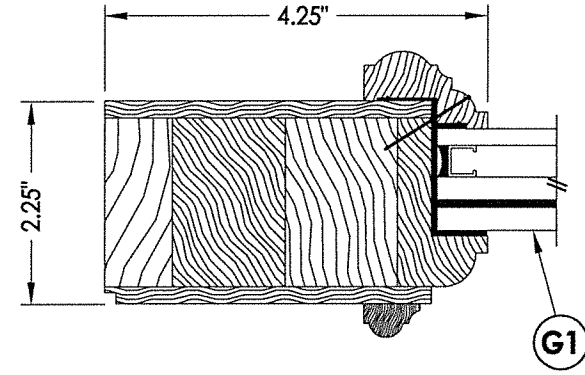

1  
3 HORIZONTAL CROSS SECTION

NOTE:  
1. ALL FRAME CORNERS SECURED WITH (1) 1/4" X 6" LAG SCREW.

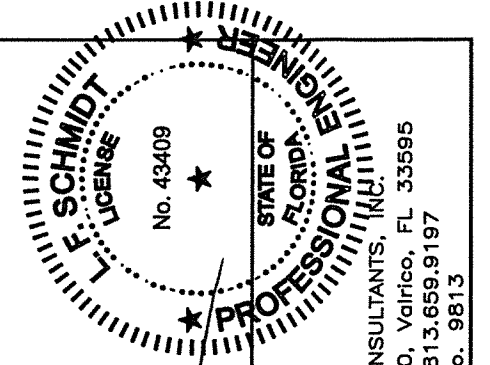

*LFS*

October 12, 2017  
Documents Prepared By:  
Lyndon F. Schmidt  
P.E. No. 43409

PRODUCT:  
SOUTHEASTERN SASH & DOOR  
WOOD DOOR

PART OR ASSEMBLY:  
TRANSOM PANEL DETAILS

NO.	DATE	DESCRIPTION	BY
1	10/12/17	UPDATE TO 6TH ED. (2017) FBC	LFS

REVISIONS

DATE: 5/10/17

SCALE: N.T.S.

DWG. BY: JK

CHK. BY: LFS

DRAWING NO.:  
FL-22347.11

SHEET 3 OF 12

*RW* BUILDING CONSULTANTS, INC.  
P.O. Box 230, Vairico, FL 33595  
Phone No.: 813.659.9197  
FBPE C.A. No. 9813

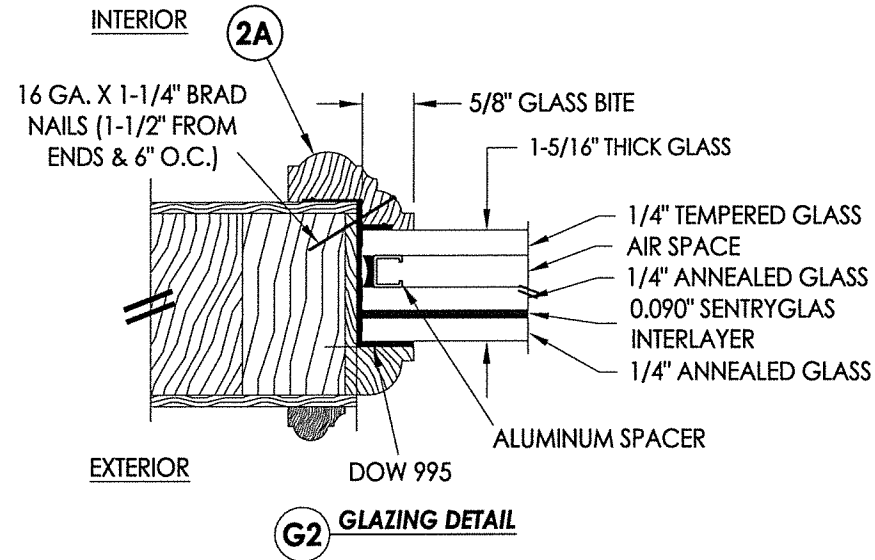
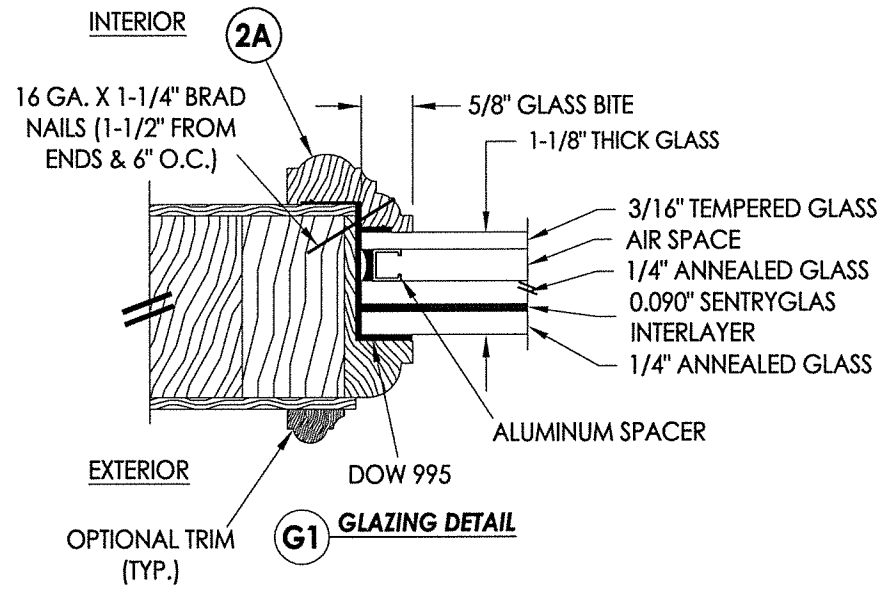

NOTE: GLAZING > 36\"/>

INTERIOR

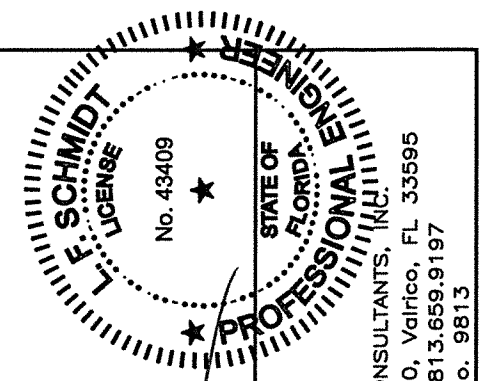
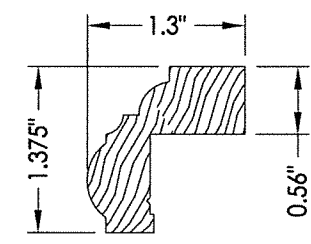
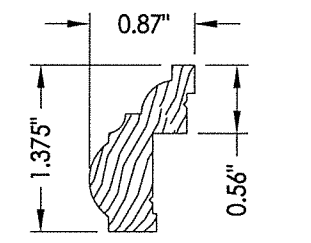
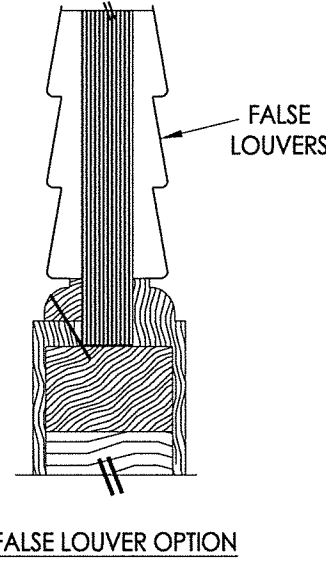
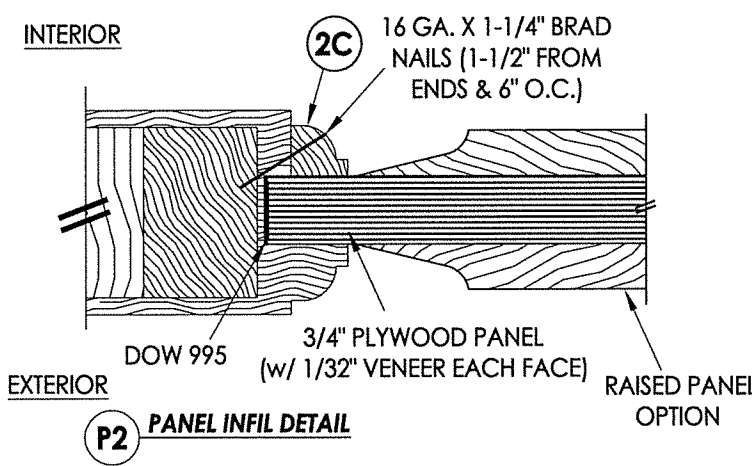
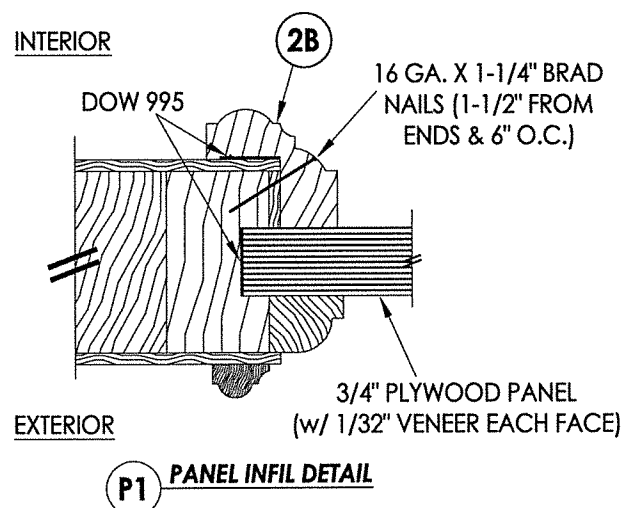

October 12, 2017  
 Documents Prepared By:  
 Lyndon F. Schmidt  
 P.E. No. 43409  
 R.W. BUILDING CONSULTANTS, INC.  
 P.O. Box 230, Vairco, FL 33595  
 Phone No.: 813.659.9197  
 FBPE C.A. No. 9813

PRODUCT:	SOUTHEASTERN SASH & DOOR WOOD DOOR
PART OR ASSEMBLY:	GLAZING & PANEL INFIL DETAILS

NO.	DATE	DESCRIPTION	BY
1	10/12/17	UPDATE TO 6TH ED. (2017) FBC	LFS

DATE:	5/10/17
SCALE:	N.T.S.
DWG. BY:	JK
CHK. BY:	LFS
DRAWING NO.:	FL-22347.11
SHEET	4 OF 12



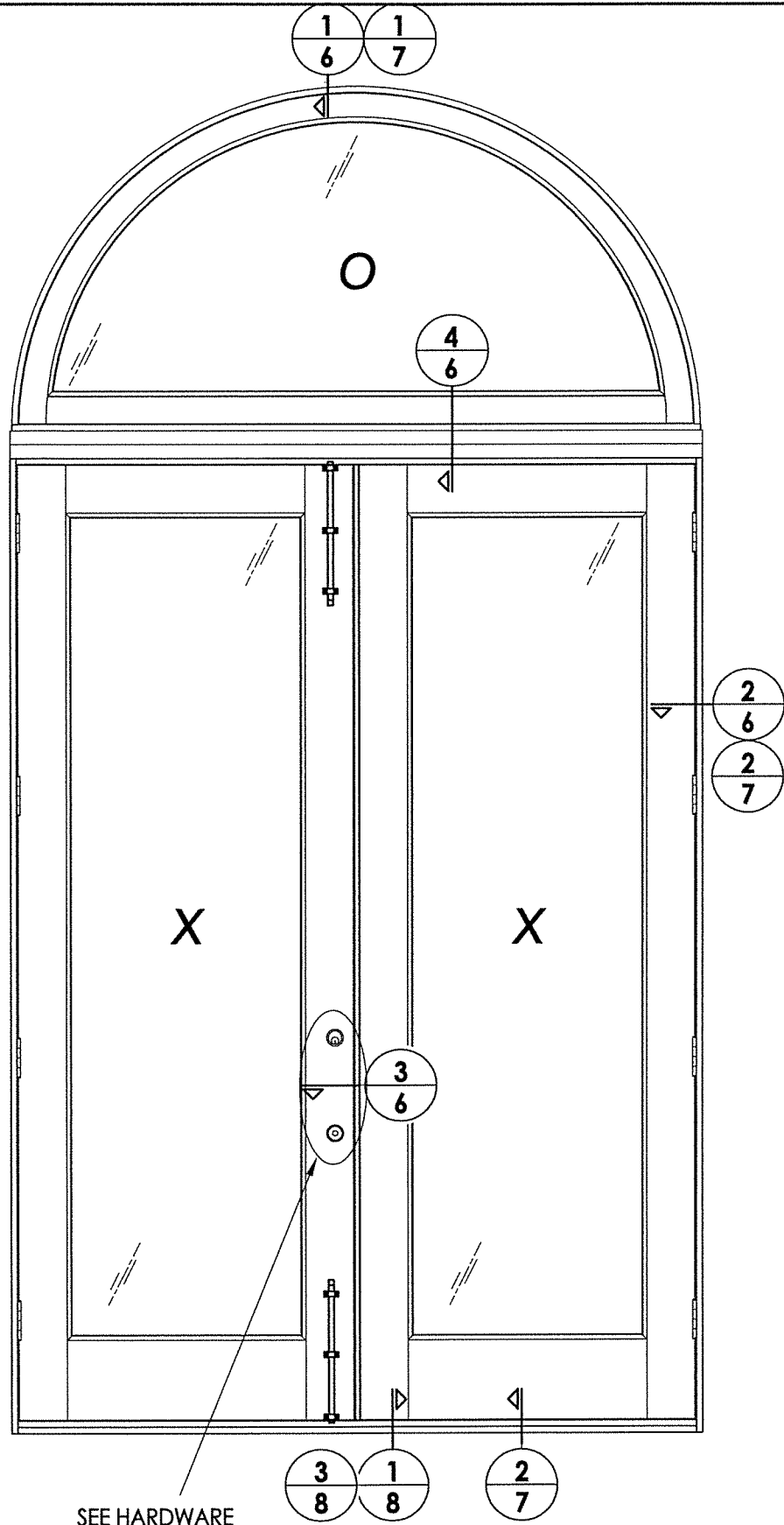

SEE HARDWARE CHART

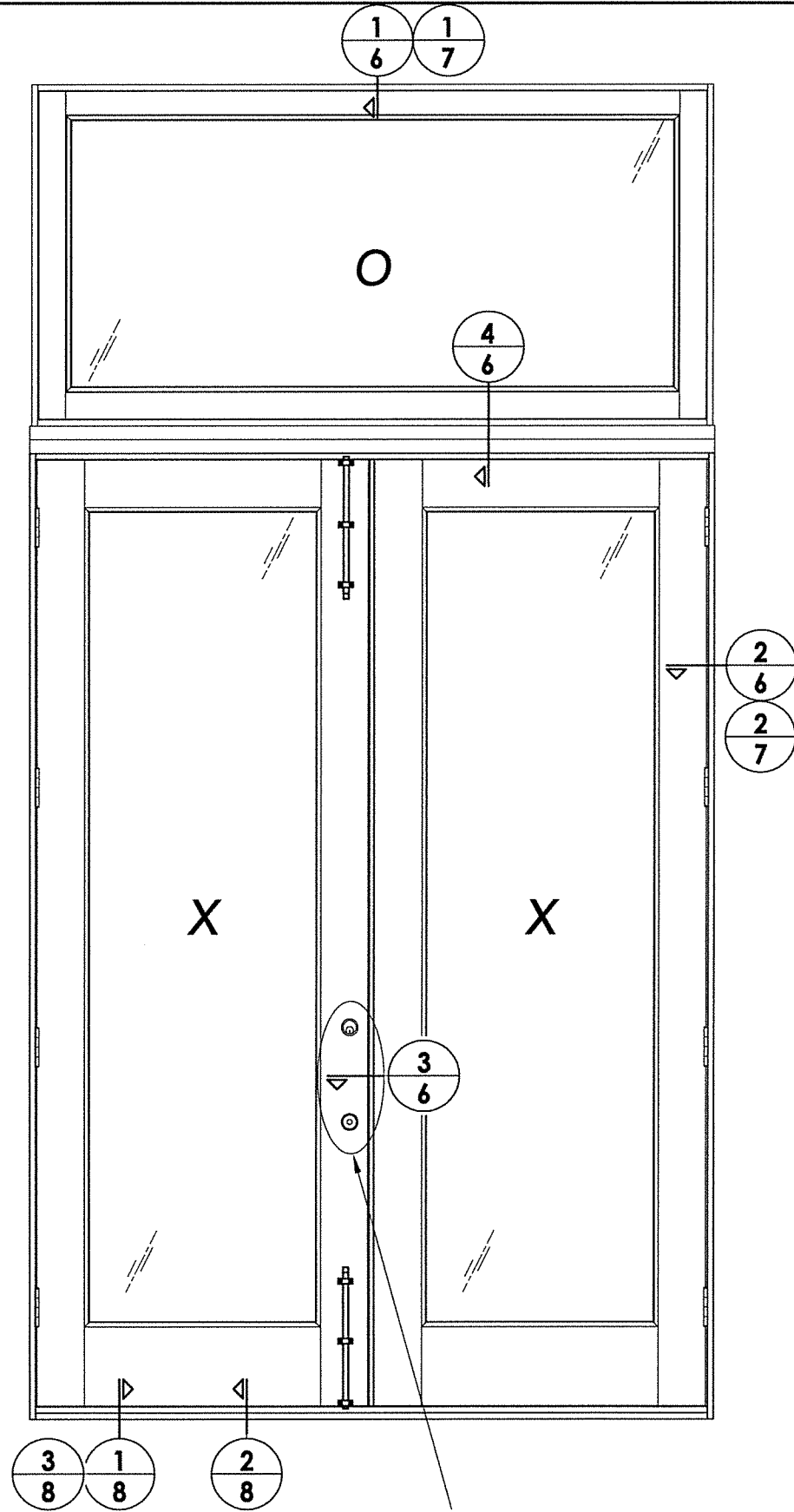

SEE HARDWARE CHART

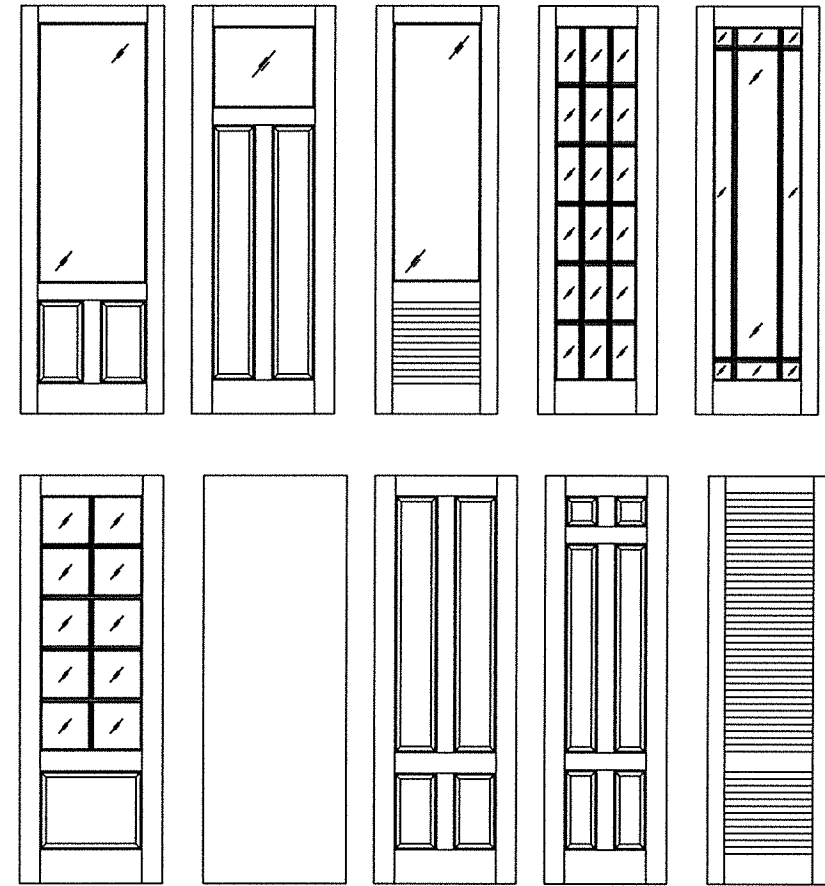

**SOUTHEASTERN SASH & DOOR Door Panel Options**

Panel options shown are for illustration and are representative only. Surface applied muntins are used for simulated divided lites shown.

HARDWARE TABLE	
MANUFACTURER	MODEL
KWIKSET	KNOB: SIGNATURE SERIES DEADBOLT: SIGNATURE SERIES (980)

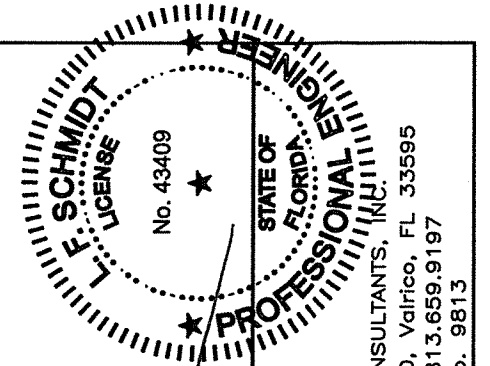

October 12, 2017  
 Documents Prepared By:  
 Lyndon F. Schmidt  
 P.E. No. 43409

*RW* BUILDING CONSULTANTS, INC.  
 P.O. Box 230, Valrico, FL 33595  
 Phone No.: 813.659.9197  
 FBPE C.A. No. 9813

PRODUCT: SOUTHEASTERN SASH & DOOR WOOD DOOR  
 PART OR ASSEMBLY: ELEVATIONS

NO.	DATE	REVISIONS
1	10/12/17	UPDATE TO 6TH ED. (2017) FBC
		LFS
		BY

DATE: 05/10/17  
 SCALE: N.T.S.  
 DWG. BY: JK  
 CHK. BY: LFS  
 DRAWING NO.: FL-22347.11  
 SHEET 5 OF 12

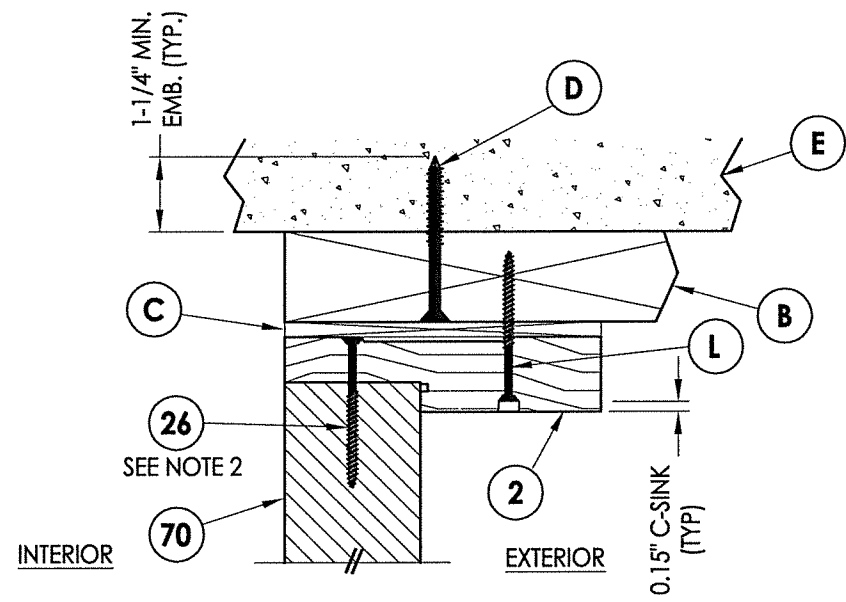

**1** VERTICAL CROSS SECTION  
**6** Shown w/ 2X Buck  
 Inswing shown (Outswing similar)

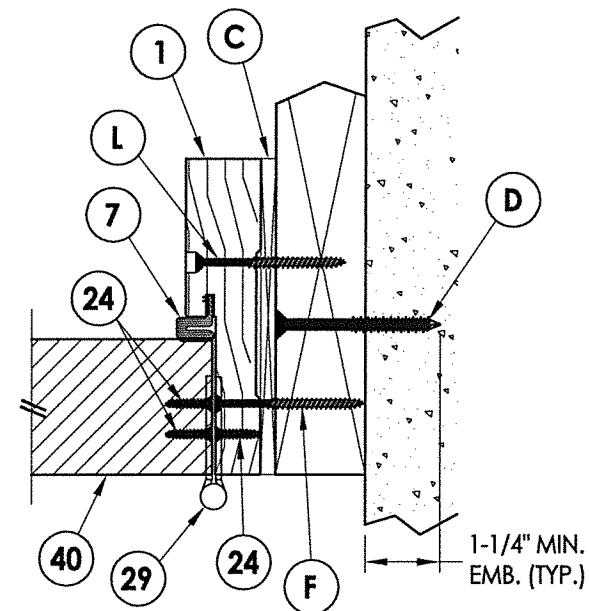

**2** HORIZONTAL CROSS SECTION  
**6** Shown w/ 2X Buck  
 Inswing shown (Outswing similar)

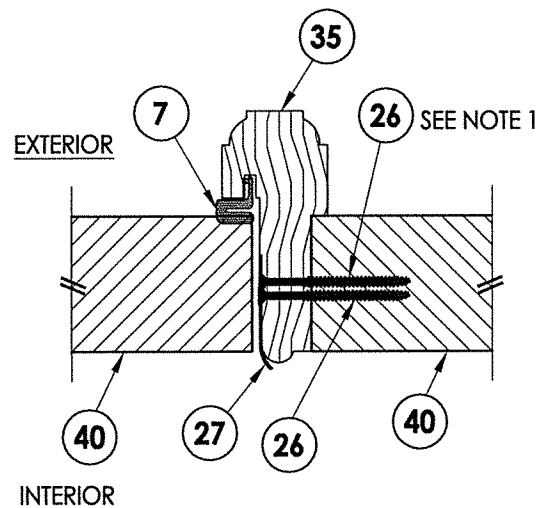

**4** HORIZONTAL CROSS SECTION  
**6** Inswing shown (Outswing similar)

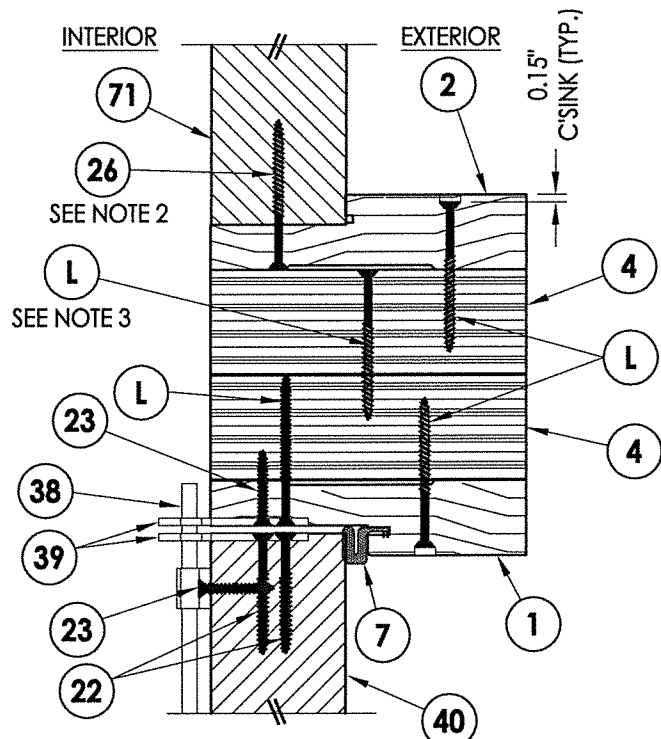

**5** VERTICAL CROSS SECTION  
**6** Inswing Shown

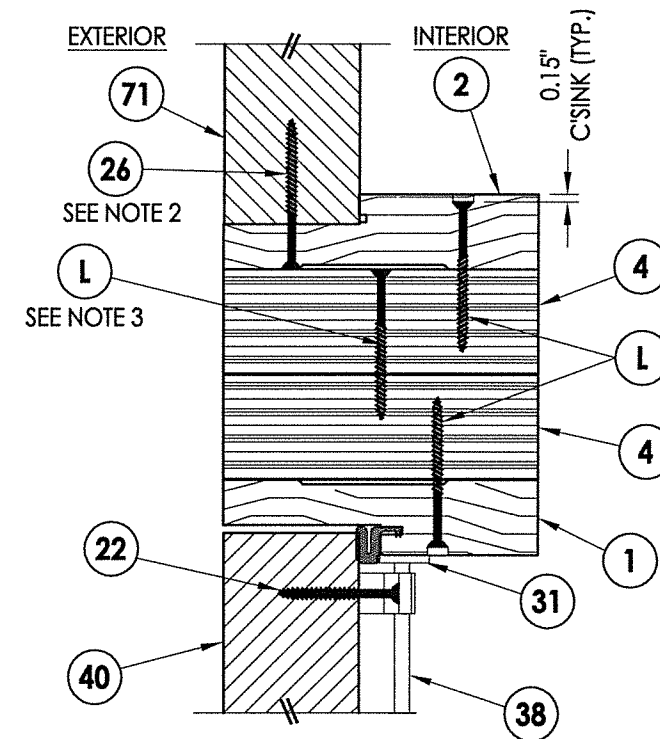

**6** VERTICAL CROSS SECTION  
**6** Outswing Shown

NOTES:

- Item #26 located 4" from each end & 9 more equally spaced (11 total).
- Item #26 located 4" from each end & 1 at the center line (3 total).
- Item #L located 24" from each end & 1 more at the center line (3 total).

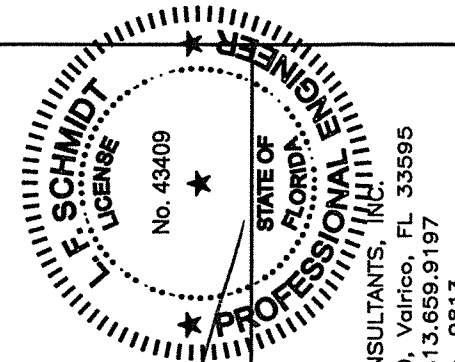

October 12, 2017  
 Documents Prepared By:  
 Lyndon F. Schmidt  
 P.E. No. 43409

**RW** BUILDING CONSULTANTS, INC.  
 P.O. Box 230, Valrico, FL 33595  
 Phone No.: 813.659.9197  
 FBPE C.A. No. 9813

PRODUCT:  
 SOUTHEASTERN SASH & DOOR  
 WOOD DOOR

PART OR ASSEMBLY:  
 HORIZONTAL & VERTICAL  
 CROSS SECTIONS (2X BUCK)

NO.	DATE	BY	REVISIONS
1	10/12/17	LFS	UPDATE TO 6TH ED. (2017) FBC

DATE: 5/10/17  
 SCALE: N.T.S.  
 DWG. BY: JK  
 CHK. BY: LFS  
 DRAWING NO.: FL-22347.11  
 SHEET 6 OF 12

NOTES:

- Item #26 located 4" from each end & 1 at the center line (3 total).

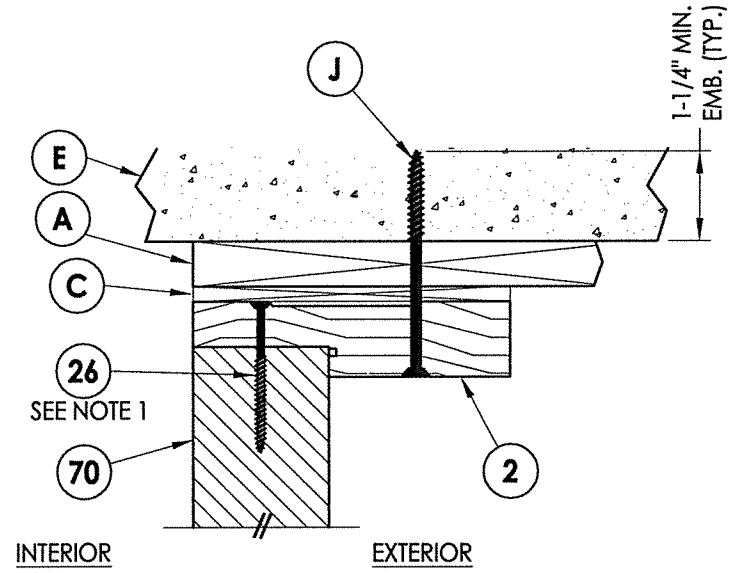

**1 VERTICAL CROSS SECTION**  
**7** Shown w/ 1X Buck  
 Inswing shown (Outswing similar)

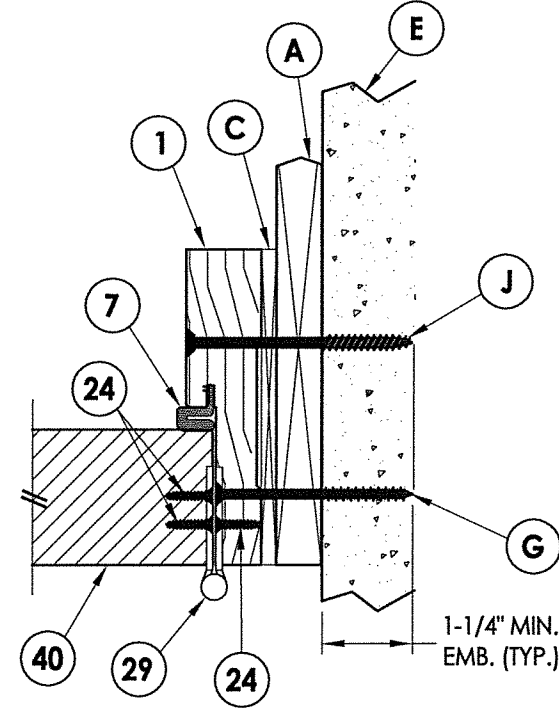

**2 HORIZONTAL CROSS SECTION**  
**7** Shown w/ 1X Buck  
 Inswing shown (Outswing similar)

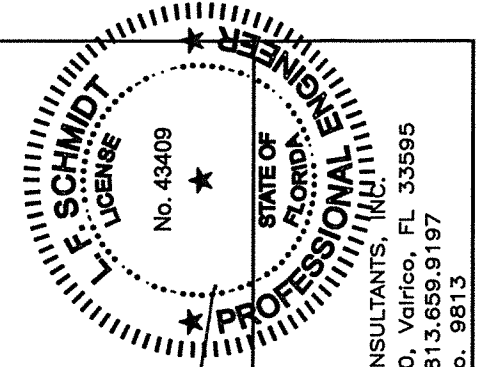

October 12, 2017  
 Documents Prepared By:  
 Lyndon F. Schmidt  
 P.E. No. 43409  
*LFS*  
 RW BUILDING CONSULTANTS, INC.  
 P.O. Box 230, Valrico, FL 33595  
 Phone No.: 813.659.9197  
 FBPE C.A. No. 9813

PRODUCT:  
 SOUTHEASTERN SASH & DOOR  
 WOOD DOOR  
 PART OR ASSEMBLY:  
 HORIZONTAL & VERTICAL  
 CROSS SECTIONS (1X BUCK)

NO.	DATE	BY	REVISIONS
1	10/12/17	FBC	UPDATE TO 6TH ED. (2017)
		LFS	

DATE: 5/10/17  
 SCALE: N.T.S.  
 DWG. BY: JK  
 CHK. BY: LFS  
 DRAWING NO.:  
 FL-22347.11  
 SHEET 7 OF 12

R:\Clients\Southeastern Sash & Door\A - Florida Product Approvals\FL-22347\C - Drawings\FL-22347\9-11.dwg, 11.8

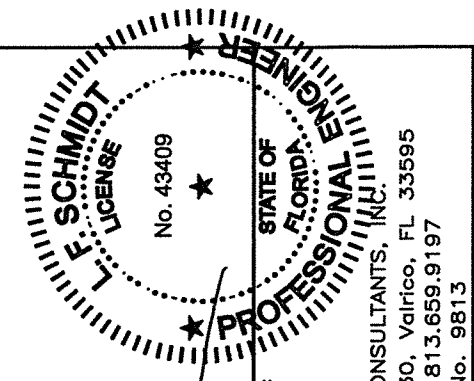
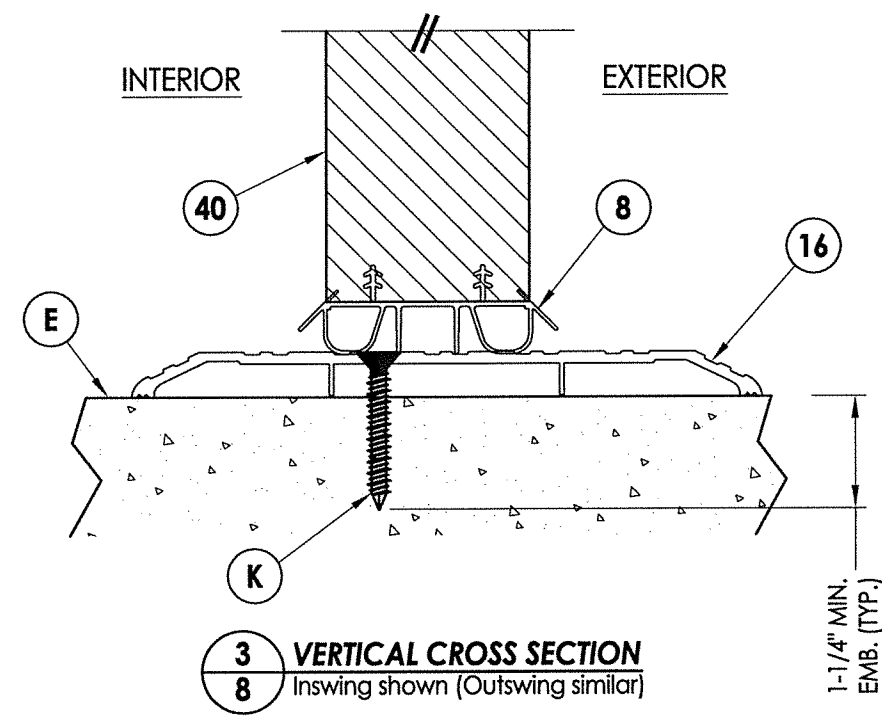
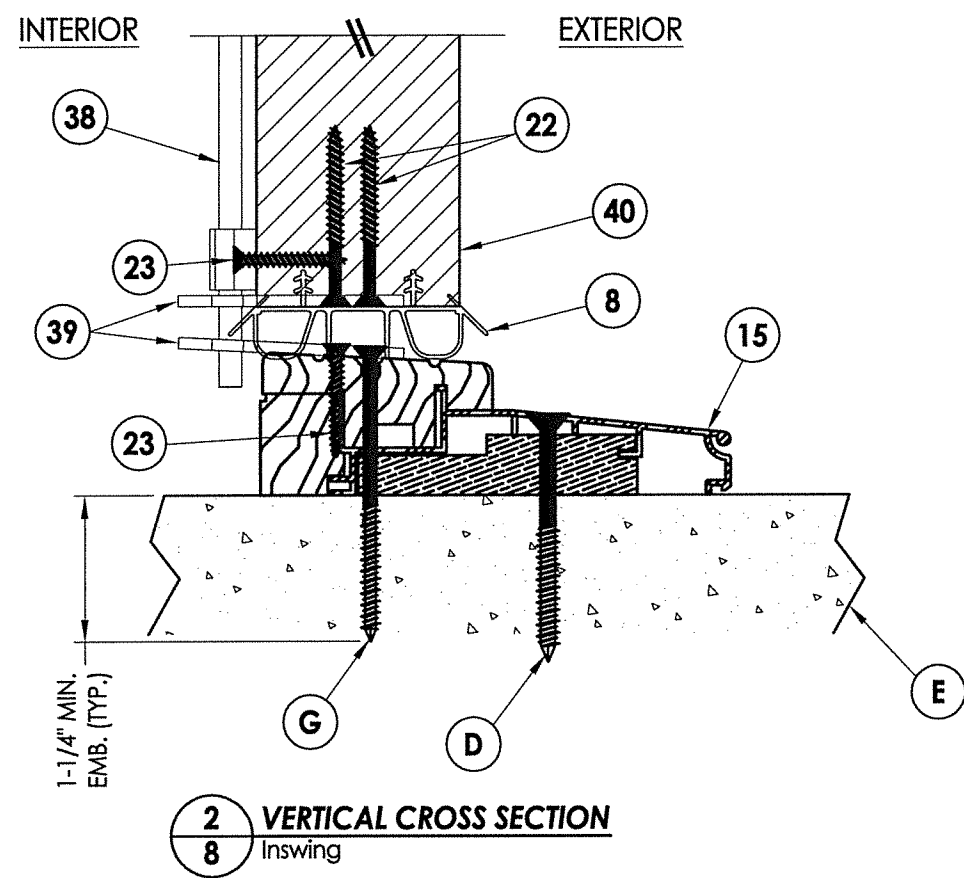
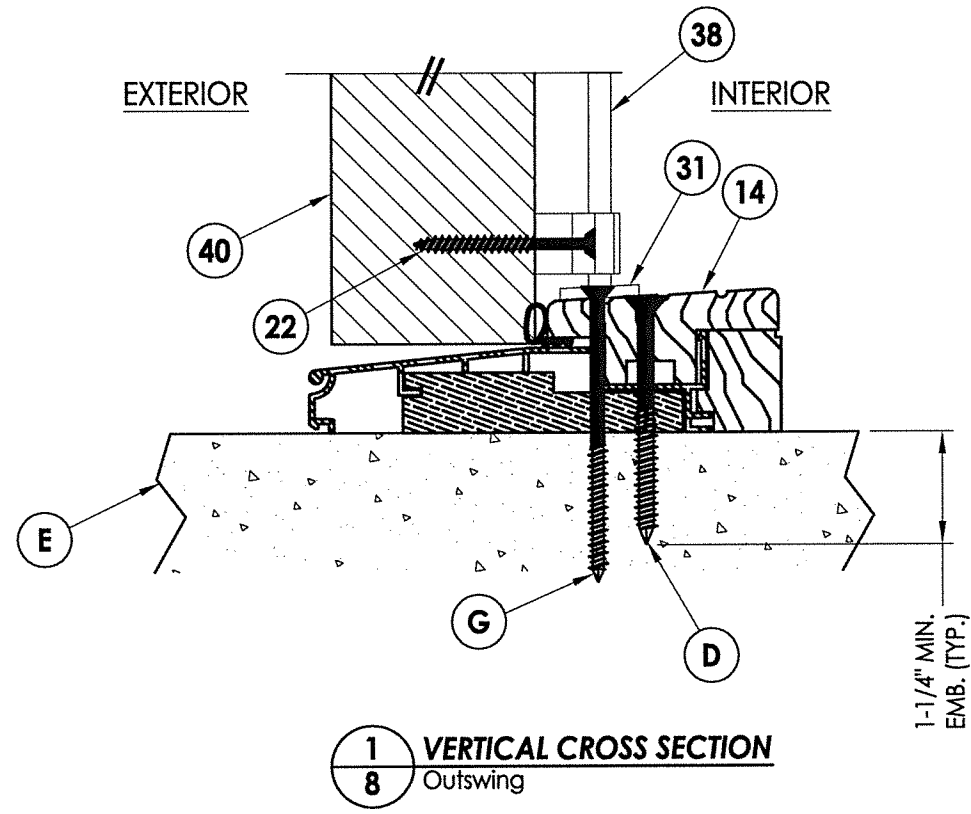

October 12, 2017  
 Documents Prepared By:  
 Lyndon F. Schmidt  
 P.E. No. 43409  
 RW BUILDING CONSULTANTS, INC.  
 P.O. Box 230, Vairico, FL 33595  
 Phone No.: 813.659.9197  
 FBPE C.A. No. 9813

PRODUCT:  
 SOUTHEASTERN SASH & DOOR  
 WOOD DOOR  
 PART OR ASSEMBLY:  
 VERTICAL CROSS  
 SECTIONS (THRESHOLD)

NO.	DATE	BY	REVISIONS
1	10/12/17	FBC	UPDATE TO 6TH ED. (2017)
		LFS	

DATE: 5/10/17  
 SCALE: N.T.S.  
 DWG. BY: JK  
 CHK. BY: LFS  
 DRAWING NO.: FL-22347.11  
 SHEET 8 OF 12



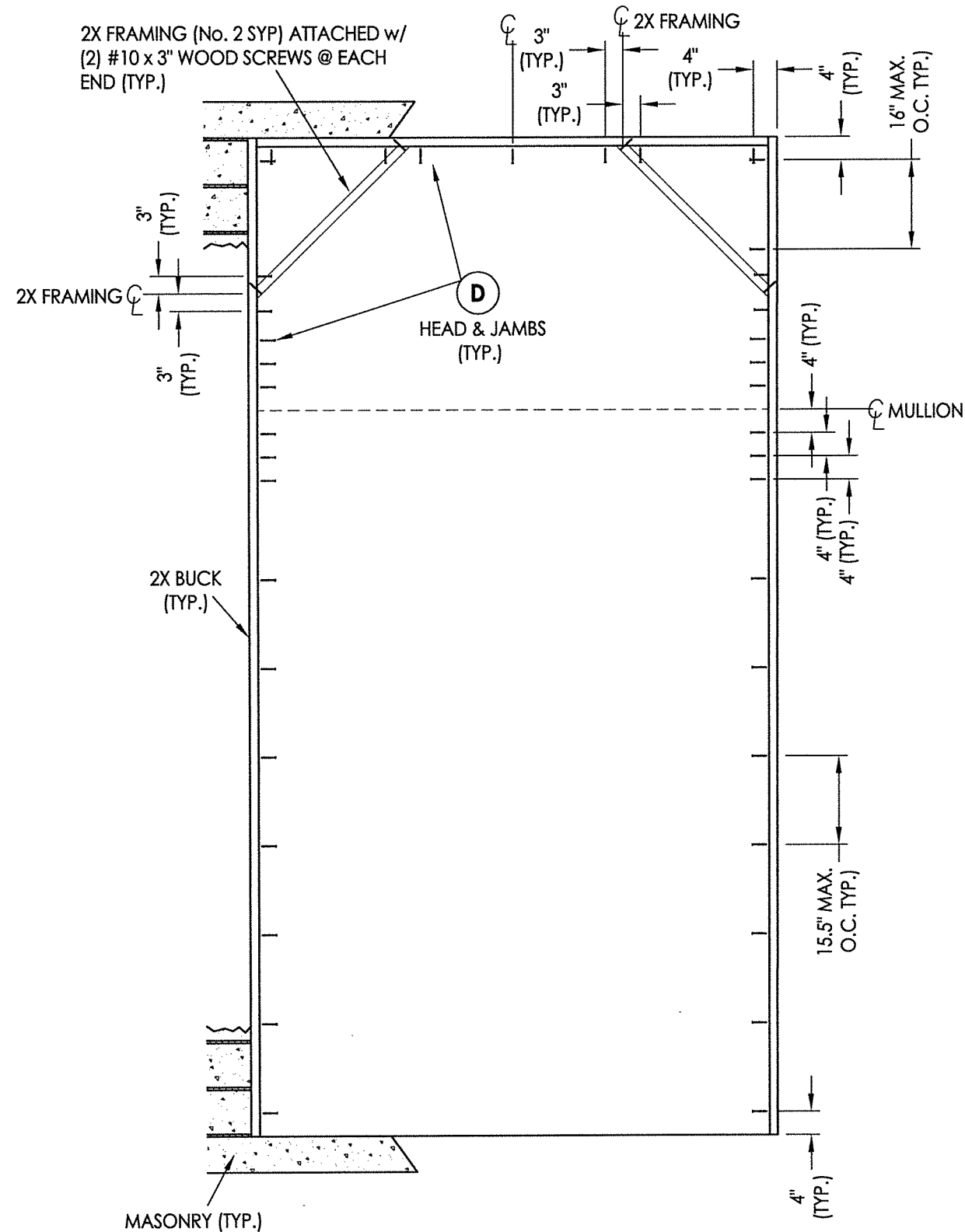

**2X BUCK ANCHORING**  
O/XX (Arch Top Transom)

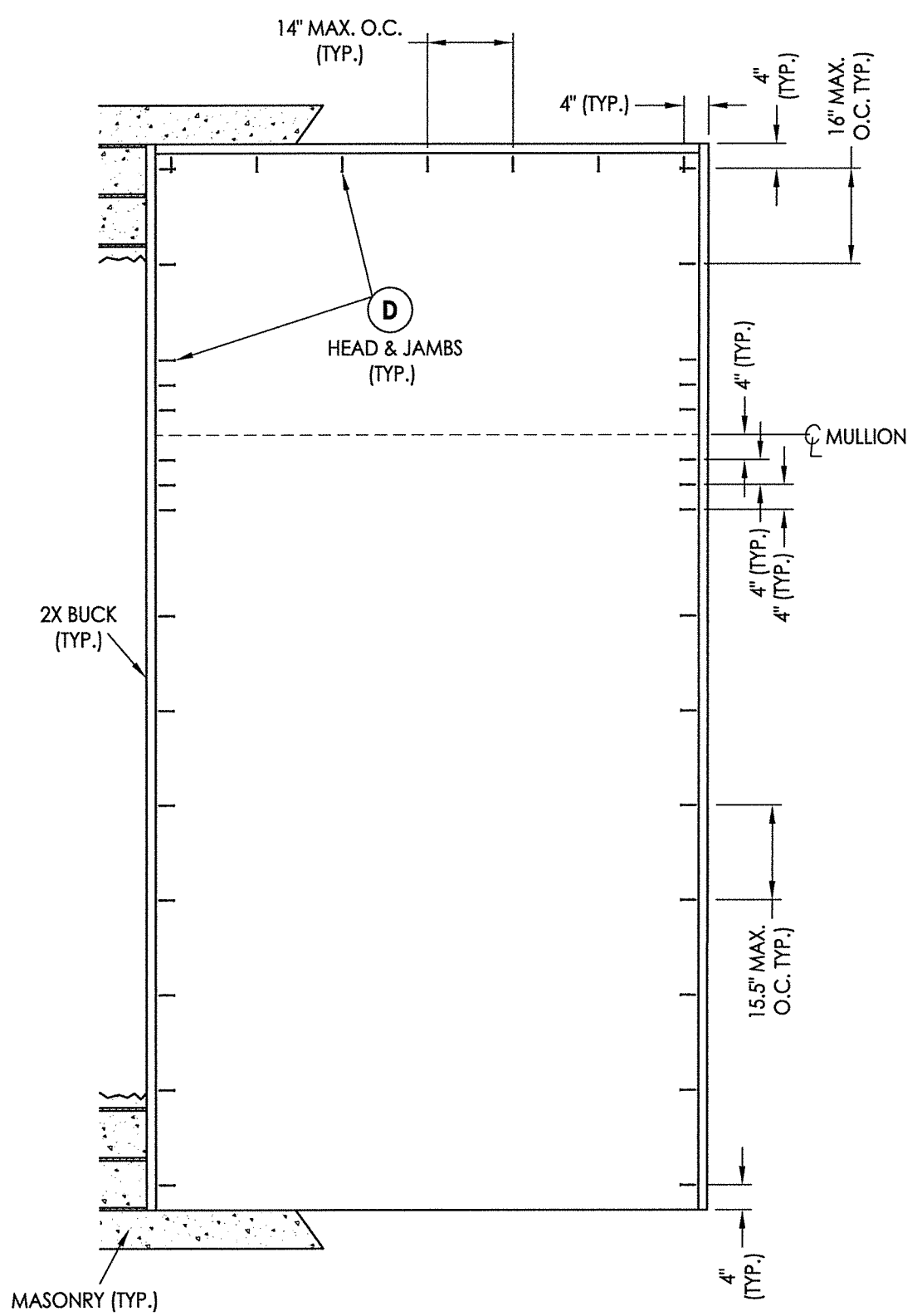

**2X BUCK ANCHORING**  
O/XX

NOTE:  
1. ALL FRAME CORNERS SECURED WITH (3) #8 X 2-1/2" FH DEEP THREAD WOOD SCREWS @ SILL.

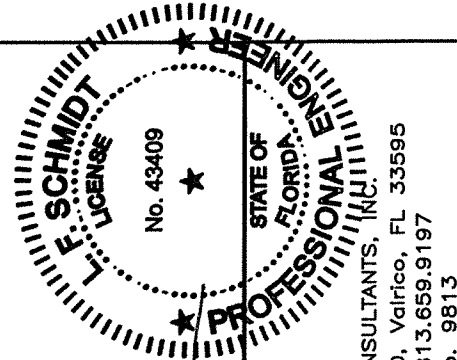

October 12, 2017  
 Documents Prepared By:  
 Lyndon F. Schmidt  
 P.E. No. 43409  
 R.W. BUILDING CONSULTANTS, INC.  
 P.O. Box 230, Valrico, FL 33595  
 Phone No.: 813.659.9197  
 FBPE C.A. No. 9813

PRODUCT:	SOUTHEASTERN SASH & DOOR WOOD DOOR
PART OR ASSEMBLY:	BUCK ANCHORING

NO.	DATE	BY	REVISIONS
1	10/12/17	FBC	UPDATE TO 6TH ED. (2017)

DATE:	5/10/17
SCALE:	N.T.S.
DWG. BY:	JK
CHK. BY:	LFS
DRAWING NO.:	FL-22347.11
SHEET	9 OF 12

R:\Clients\Southeastern Sash & Door\A - Florida Product Approvals\FL-22347\C - Drawings\FL-22347 (2017)\FL-22347.9-11.dwg, 11.10

NOTE: ANCHORING OF FRAMING TO 1X BUCK IS THE RESPONSIBILITY OF THE BUILDING DESIGNER.

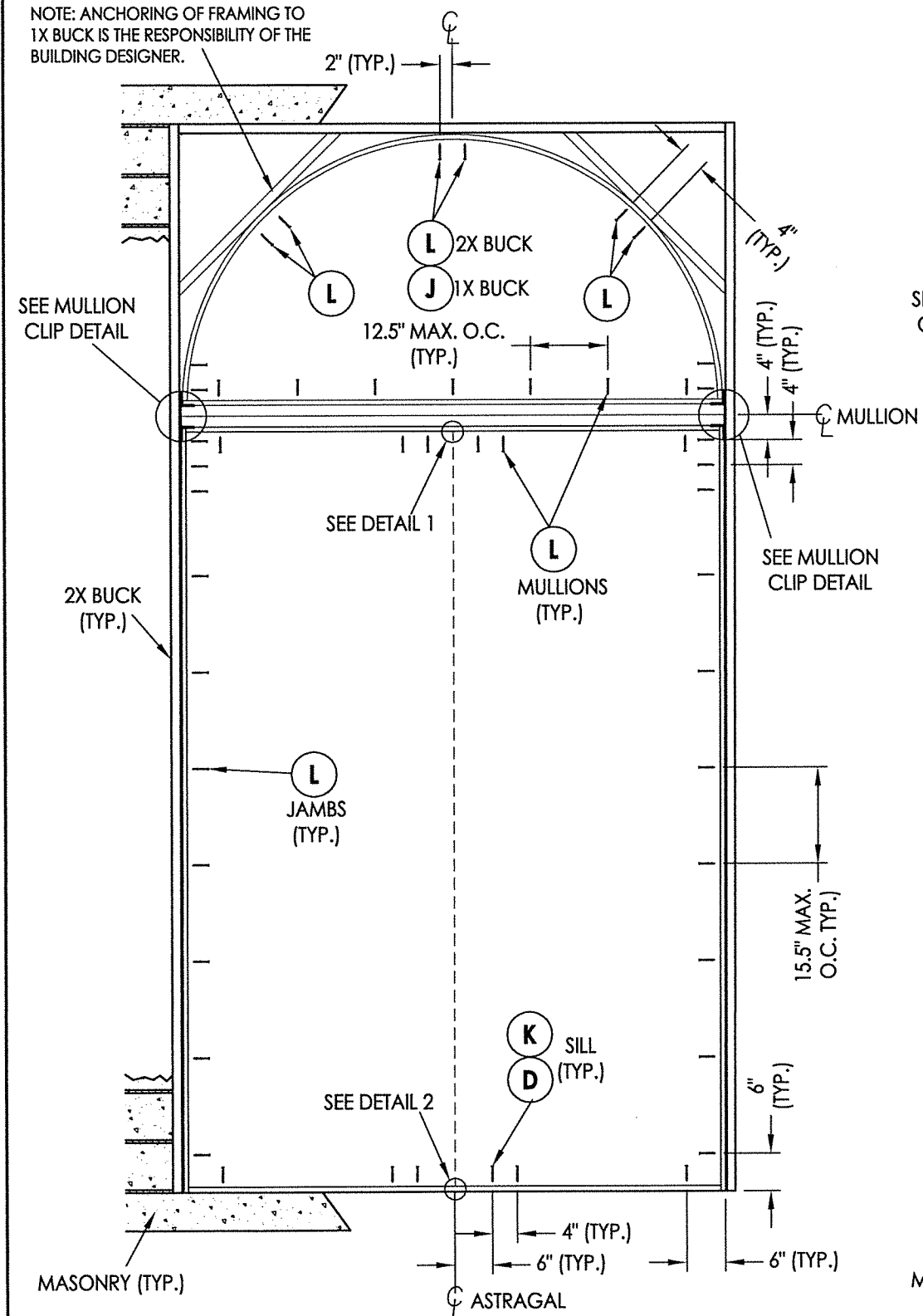

**FRAME ANCHORING**  
O/XX (Arch Top Transom)

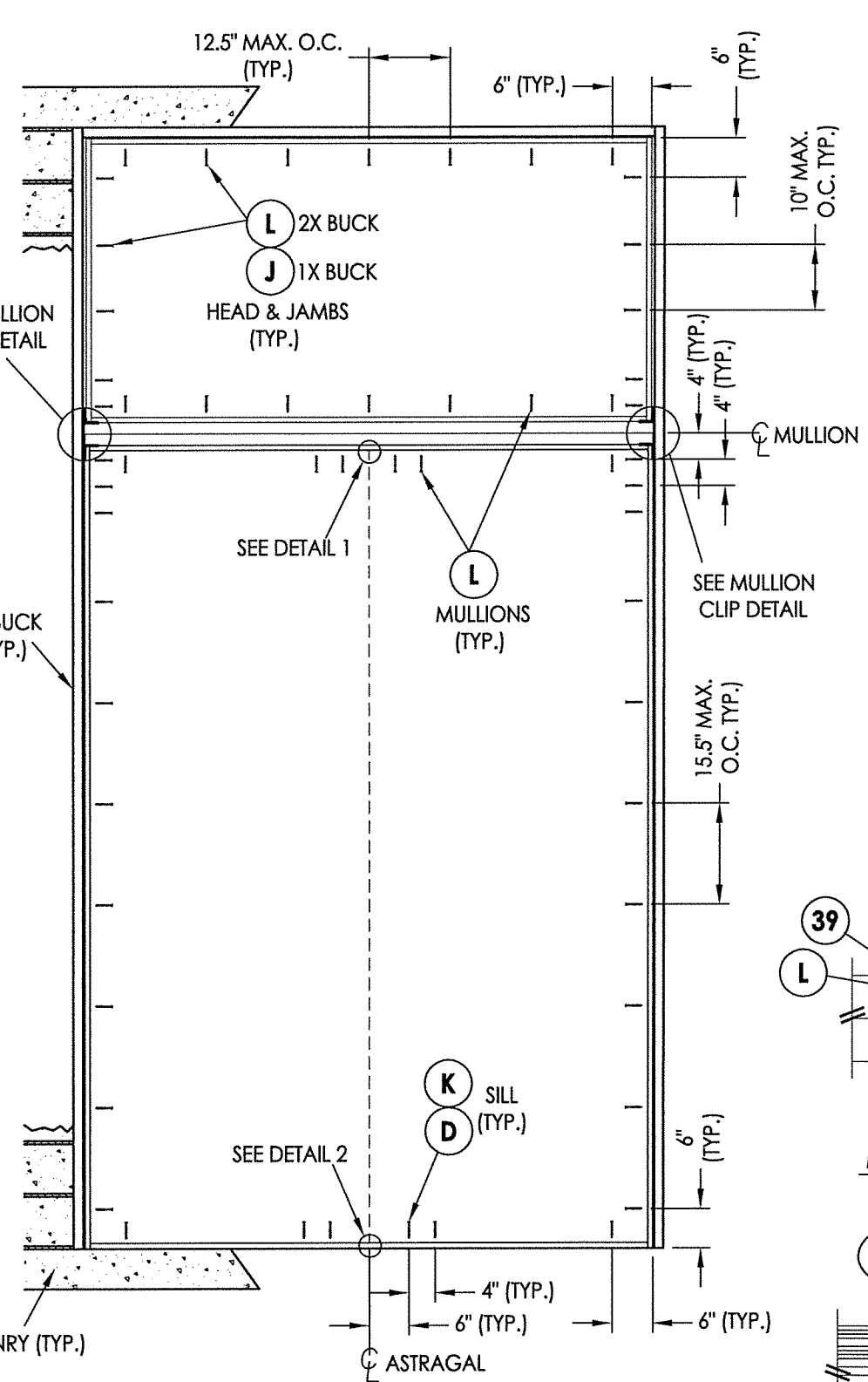

**FRAME ANCHORING**  
O/XX

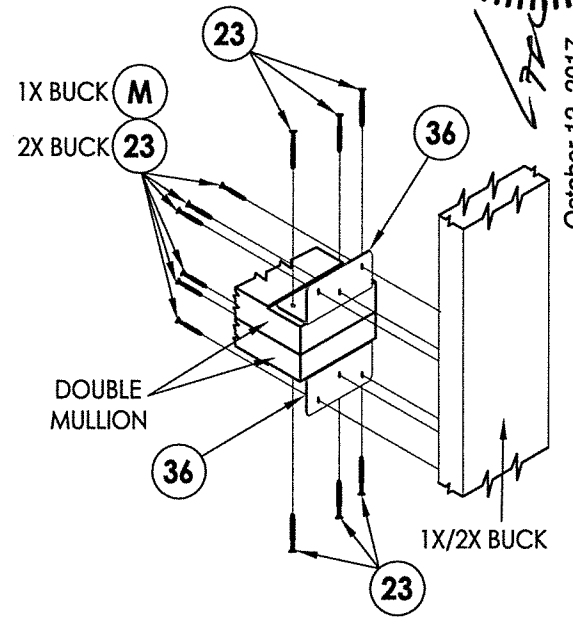

**DOUBLE MULLION CLIP DETAIL**

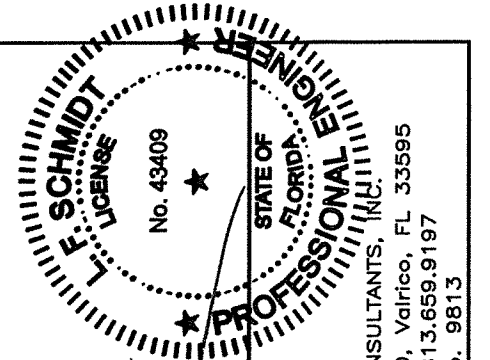
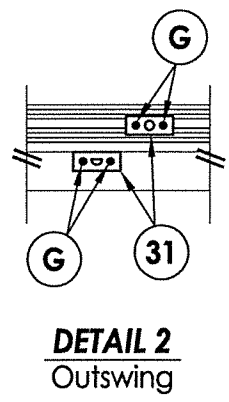
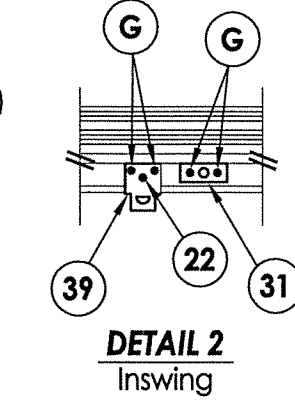
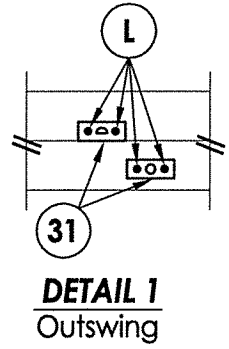
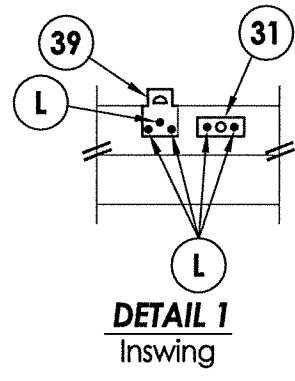

October 12, 2017  
 Documents Prepared By:  
 Lyndon F. Schmidt  
 P.E. No. 43409

PRODUCT:  
 SOUTHEASTERN SASH & DOOR  
 WOOD DOOR

PART OR ASSEMBLY:  
 FRAME ANCHORING

NO.	DATE	BY	LFS
1	10/12/17	JK	FBC

DATE: 5/10/17  
 SCALE: N.T.S.  
 DWG. BY: JK  
 CHK. BY: LFS  
 DRAWING NO.: FL-22347.11  
 SHEET 10 OF 12

© 2017 R.W. BUILDING CONSULTANTS INC.

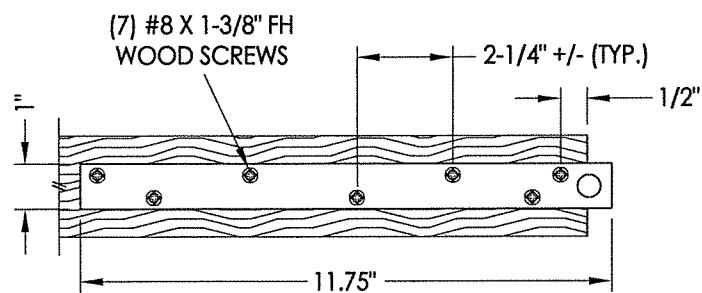

**FLUSHBOLT REINFORCEMENT**  
AT TOP & BOTTOM OF DOOR PANEL  
(3/16" THICK STEEL)

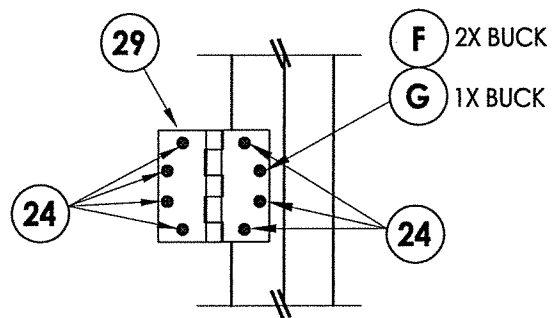

**HINGE DETAIL**

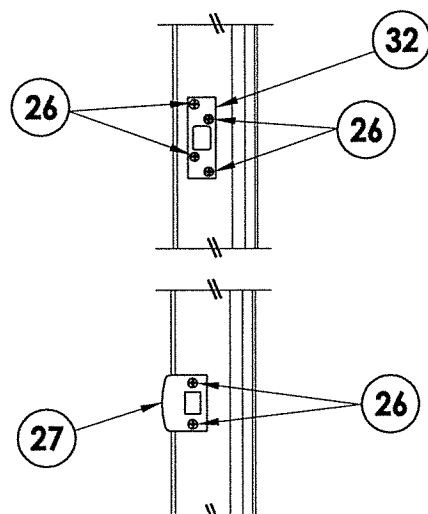

**LATCH & DEADBOLT STRIKE DETAIL**

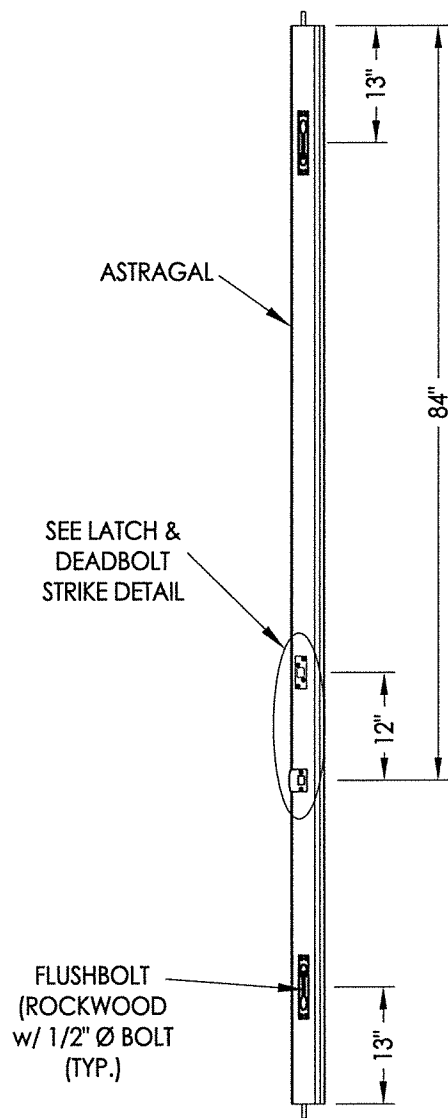

**LATCH & DEADBOLT DETAILS**

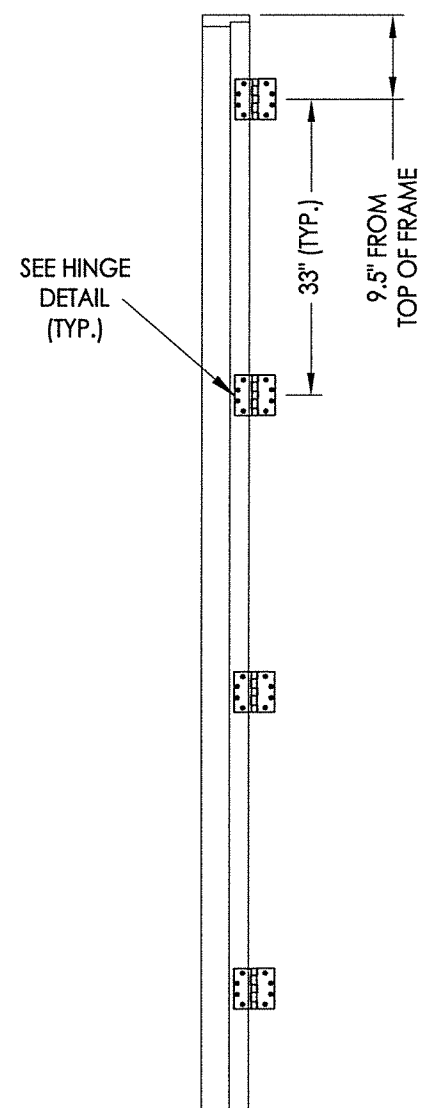

**HINGE JAMB**

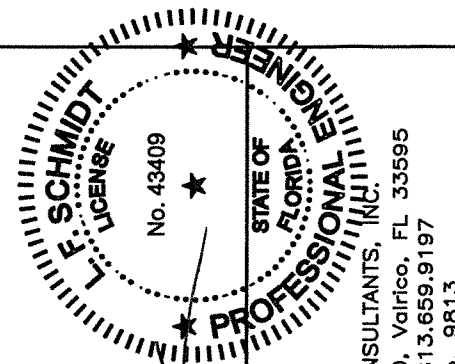

October 12, 2017  
Documents Prepared By:  
Lyndon F. Schmidt  
P.E. No. 43409

**R.W. BUILDING CONSULTANTS, INC.**  
P.O. Box 230, Valrico, FL 33595  
Phone No.: 813.659.9197  
FBPE C.A. No. 9813

PRODUCT: SOUTHEASTERN SASH & DOOR WOOD DOOR  
PART OR ASSEMBLY: HARDWARE DETAILS

NO.	DATE	REVISIONS
1	10/12/17	UPDATE TO 6TH ED. (2017) FBC LFS
		BY

DATE: 5/10/17  
SCALE: N.T.S.  
DWG. BY: JK  
CHK. BY: LFS  
DRAWING NO.: FL-22347.11  
SHEET 11 OF 12

R:\Clients\Southeastern Sash & Door\A - Florida Product Approvals\FL-22347C - Drawings\FL-22347C - 2017\FL-22347-9-11.dwg, 11.12

BILL OF MATERIALS		
ITEM #	DESCRIPTION	MATERIAL
A	1X BUCK (SG >= 0.42)	WOOD
B	2X BUCK (SG >= 0.42)	WOOD
C	1/4" MAX. SHIM SPACE	-
D	1/4" X 2-3/4" PFH ELCO OR ITW CONCRETE SCREW	STEEL
E	MASONRY - 3,000 PSI MIN. CONCRETE CONFORMING TO ACI 301 OR HOLLOW BLOCK CONFORMING TO ASTM C90	CONCRETE
F	#12 X 2-1/2" PFH WOOD SCREW	STEEL
G	3/16" X 3-1/4" PFH ITW CONCRETE SCREW	STEEL
J	1/4" X 3-3/4" PFH ELCO OR ITW CONCRETE SCREW	STEEL
K	1/4" X 1-3/4" PFH ELCO OR ITW CONCRETE SCREW	STEEL
L	#10 X 2-1/2" PFH WOOD SCREW (1.15" MIN. EMBEDMENT)	STEEL
M	3/16" X 2-1/4" PFH ITW CONCRETE SCREW	STEEL
1	JAMB (DOOR)	WOOD
2	JAMB (SIDELITE)	WOOD
4	MULLION	LVL
7	WEATHERSTRIP	FOAM
8	SWEEP	VINYL
14	OUTSWING THRESHOLD	ALUM/WOOD/COMP
15	INSWING THRESHOLD	ALUM/WOOD/COMP
22	#8 X 1-1/4" PFH WOOD SCREW	STEEL
23	#10 X 1-1/2" PFH WOOD SCREW	STEEL
24	#12 X 1" PFH WOOD SCREW	STEEL
25	#8 X 1-3/4" PFH WOOD SCREW	STEEL
26	#8 X 2-1/2" PFH WOOD SCREW	STEEL
27	LATCH STRIKE PLATE	STEEL
29	4.5" X 4.5" HINGE	STEEL
31	SHOOTBOLT STRIKE PLATE	STEEL
32	DEADBOLT SECURITY STRIKE PLATE	STEEL
35	ASTRAGAL	WOOD
36	MULLION ANGLE CLIP (USP ML24-TZ)	STEEL
38	SURFACE BOLT (EMTEK 8513 - 18" LONG)	STEEL
39	SURFACE BOLT STRIKE PLATE (INSWING)	STEEL
40	DOOR PANEL	WOOD
41	DOOR PANEL	WOOD
50	SIDELITE PANEL	WOOD
51	SIDELITE PANEL (DIRECT SET)	WOOD
70	TRANSOM PANEL	WOOD

WOOD FRAME COMPONENTS: SIPO (UTILE) (G = 0.53)

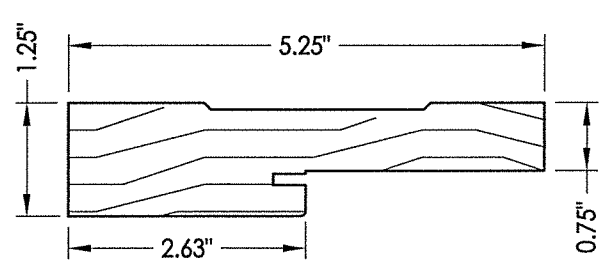

1 WOOD JAMB (DOOR)

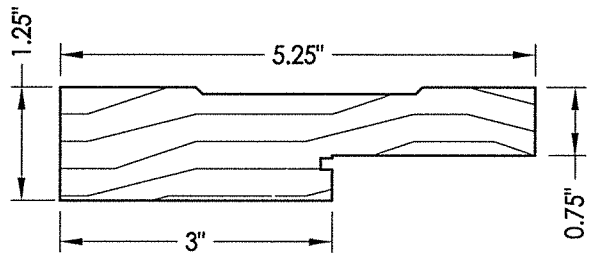

2 WOOD JAMB (SIDELITE)

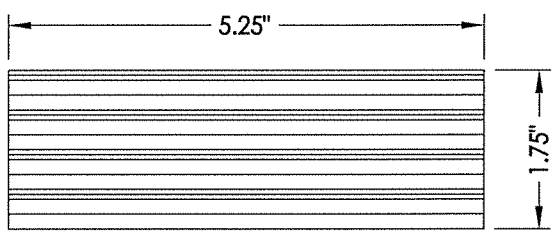

4 MULLION VERSA-LAM® 3100 Fb-2.0E

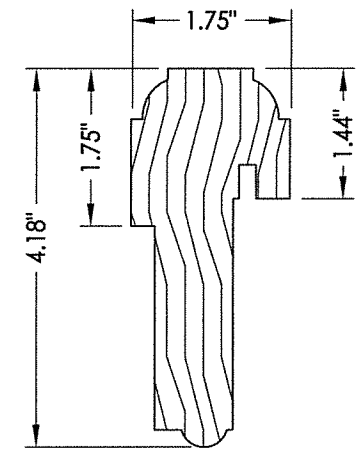

35 ASTRAGAL

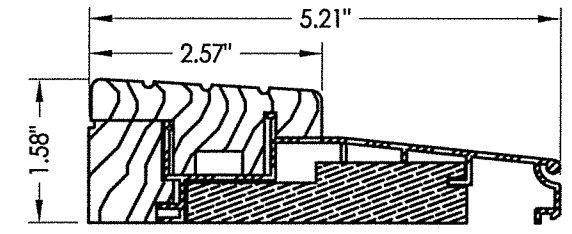

15 INSWING THRESHOLD WORLDWIDE

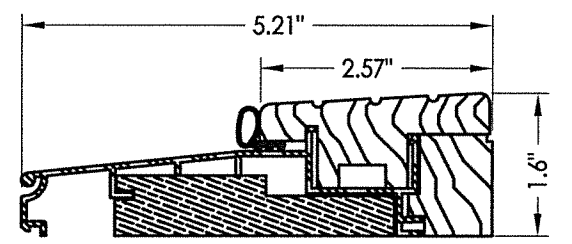

14 OUTSWING THRESHOLD WORLDWIDE

CONCRETE ANCHOR NOTES:

- Concrete anchor locations at the corners may be adjusted to maintain the min. edge distance to mortar joints.
- Concrete anchor locations noted as "MAX. ON CENTER" must be adjusted to maintain the min. edge distance to mortar joints, additional concrete anchors may be required to ensure the "MAX. ON CENTER" dimension are not exceeded.
- Concrete anchor table:

ANCHOR TYPE	ANCHOR SIZE	MIN. EMBEDMENT	MIN. CLEARANCE TO MASONRY EDGE	MIN. CLEARANCE TO ADJACENT ANCHOR
ITW TAPCON®	1/4"	1-1/4"	2"	4"
ELCO ULTRACON®	1/4"	1-1/4"	1"	4"
ITW TAPCON®	3/16"	1-1/4"	3"	1-1/2"

WOOD SCREW INSTALLATION NOTES:

- Maintain a minimum 5/8" edge distance, 1" end distance, & 1" o.c. spacing of wood screws to prevent the splitting of wood.

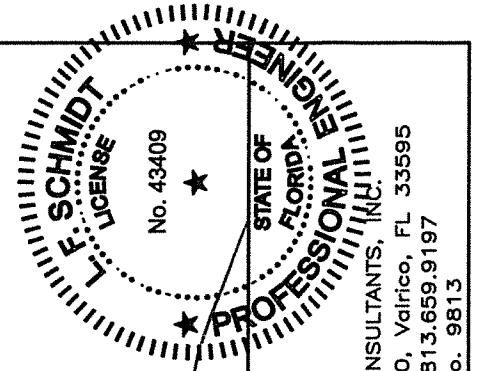

October 12, 2017  
 Documents Prepared By:  
 Lyndon F. Schmidt  
 P.E. No. 43409

RW BUILDING CONSULTANTS, INC.  
 P.O. Box 230, Valrico, FL 33595  
 Phone No.: 813.659.9197  
 FBPE C.A. No. 9813

PRODUCT:  
 SOUTHEASTERN SASH & DOOR  
 WOOD DOOR

PART OR ASSEMBLY:  
 BILL OF MATERIALS  
 & COMPONENTS

NO.	DATE	REVISIONS
1	10/12/17	UPDATE TO 6TH ED. (2017) FBC

DATE: 5/10/17  
 SCALE: N.T.S.  
 DWG. BY: JK  
 CHK. BY: LFS  
 DRAWING NO.: FL-22347.11  
 SHEET 12 OF 12